

NOTES:

SOUNDPROOF STEEL DOORS ARE CUSTOM MADE
WITH EASY TO INSTALL SLIP-IN FRAMES.

LEGEND:

- A. 1.75" THICK SOUNDPROOF STEEL DOOR..
- B. 3 CAM LIFT 900# CAPACITY HINGES - STANDARD.
- C. MANUFACTURED TO RECEIVE STANDARD
LOCKSETS OR LOCKSET OF YOUR CHOICE.

STEEL DOOR
(NO GLASS)

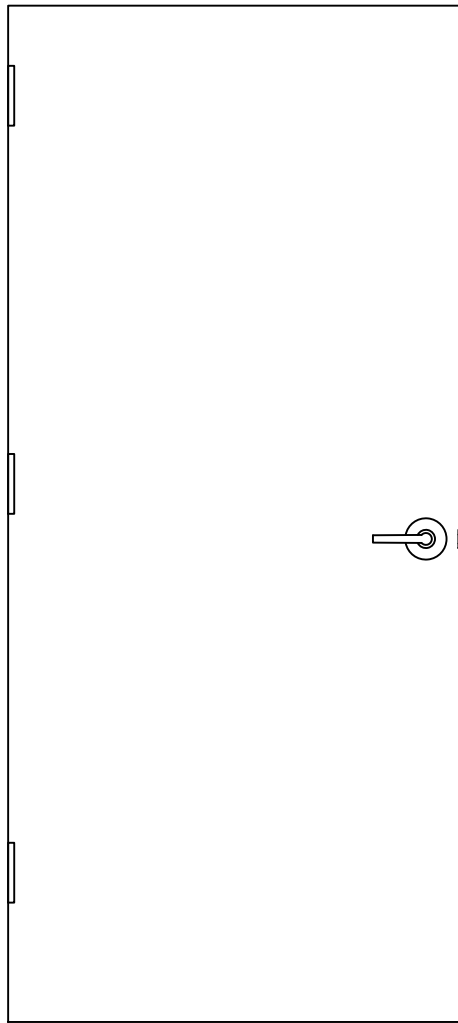

STEEL DOOR
NARROW LITE

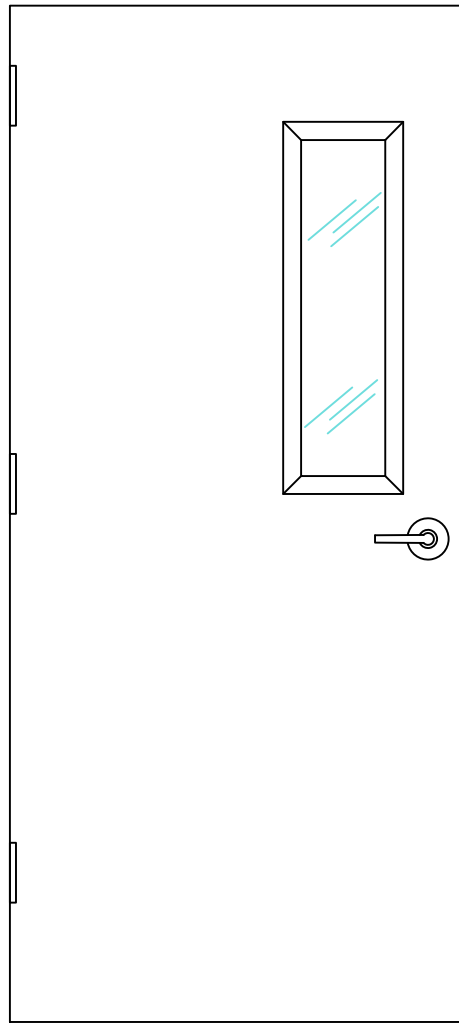

STEEL DOOR
HALF LITE

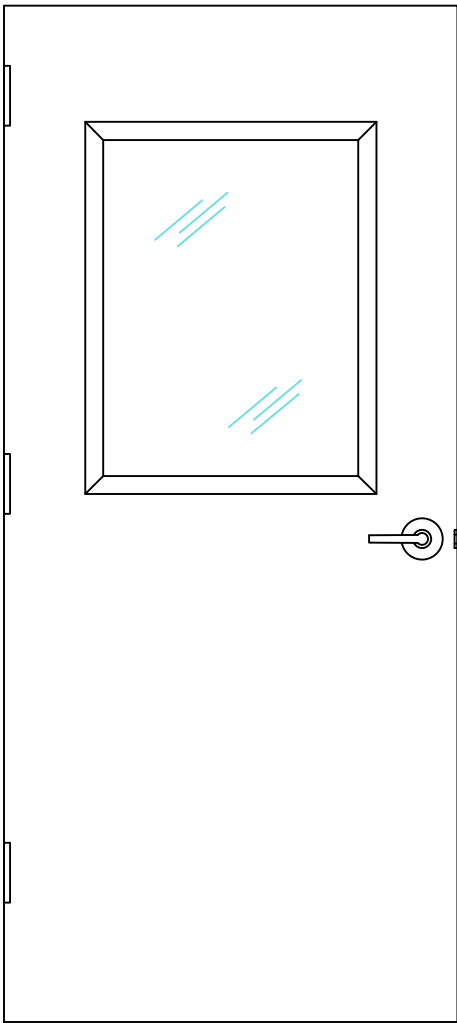

STEEL DOOR
FULL LITE

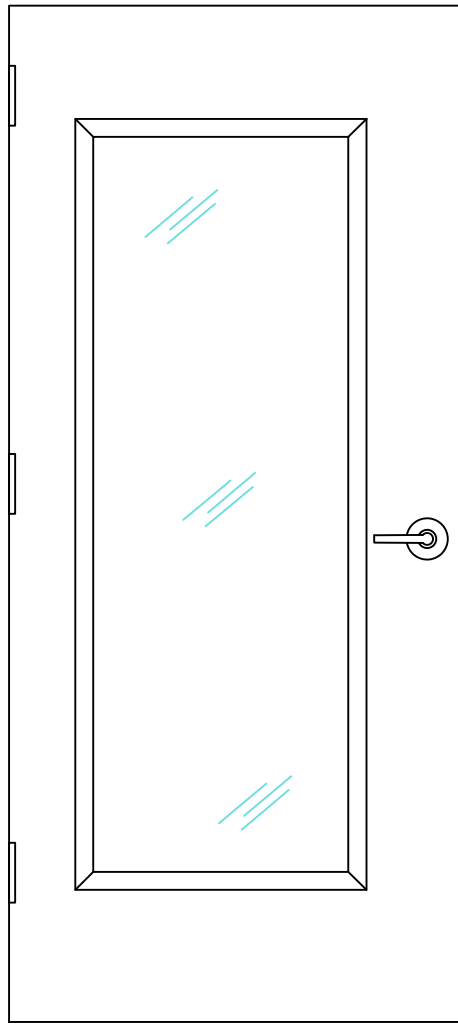

A DOOR GLASS OPTIONS
SCALE: N.T.S.

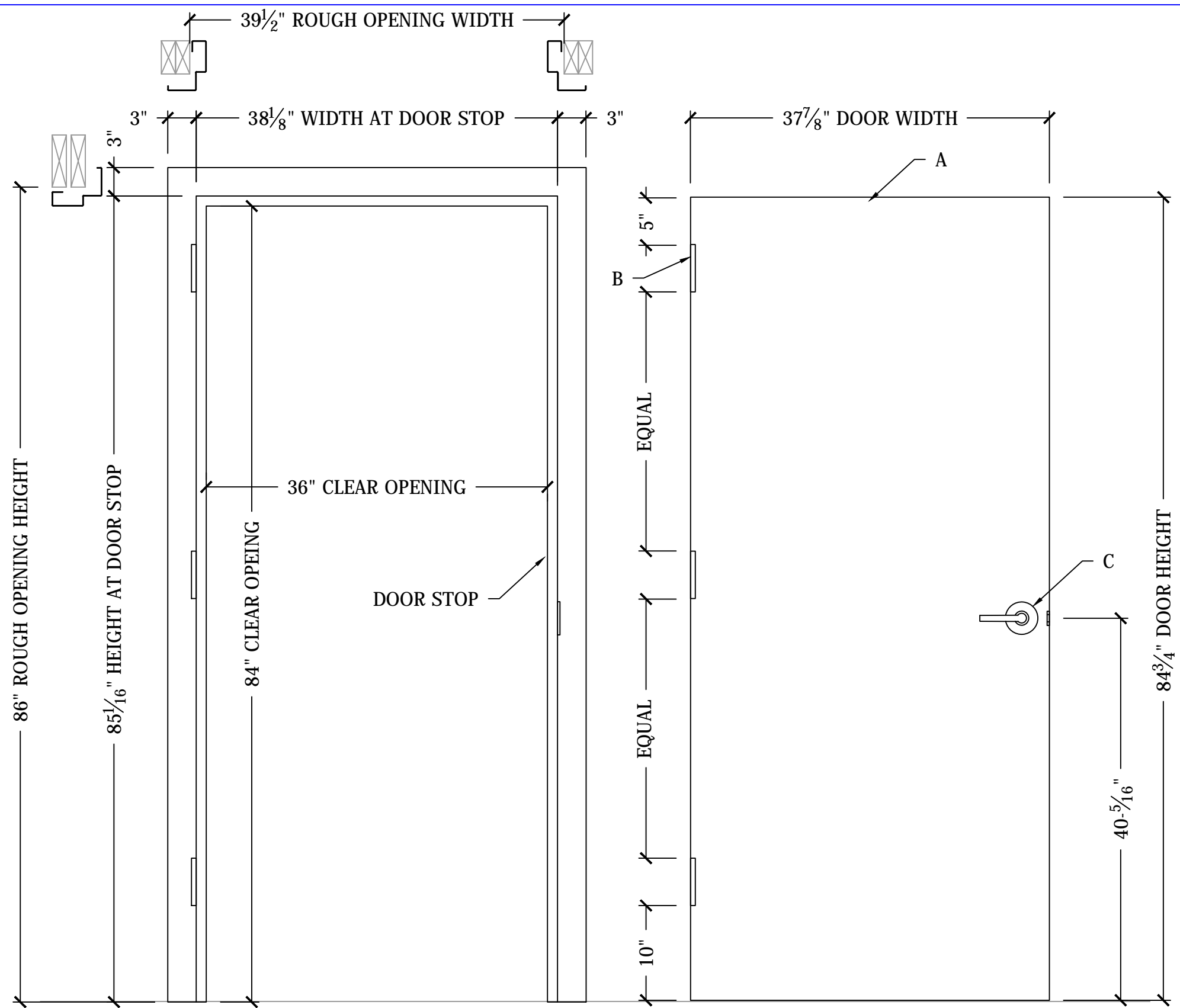

NOTES:

ELEVATION
SCALE: N.T.S.

SOUNDPROOF STEEL DOORS ARE CUSTOM MADE WITH EASY TO INSTALL SLIP-IN FRAMES.

LEGEND:

- A. 1.75" THICK SOUNDPROOF STEEL DOOR..
- B. 3 CAM LIFT 900# CAPACITY HINGES - STANDARD.
- C. MANUFACTURED TO RECEIVE STANDARD LOCKSETS OR LOCKSET OF YOUR CHOICE.

A TYPICAL 3070 DOOR

SCALE: N.T.S.



**SOUNDPROOF[®]
WINDOWS, INC.**
soundproofwindows.com
1.877.438.7843
1.877.226.4063 fax

STEEL DOOR MODEL 175C1 - 02

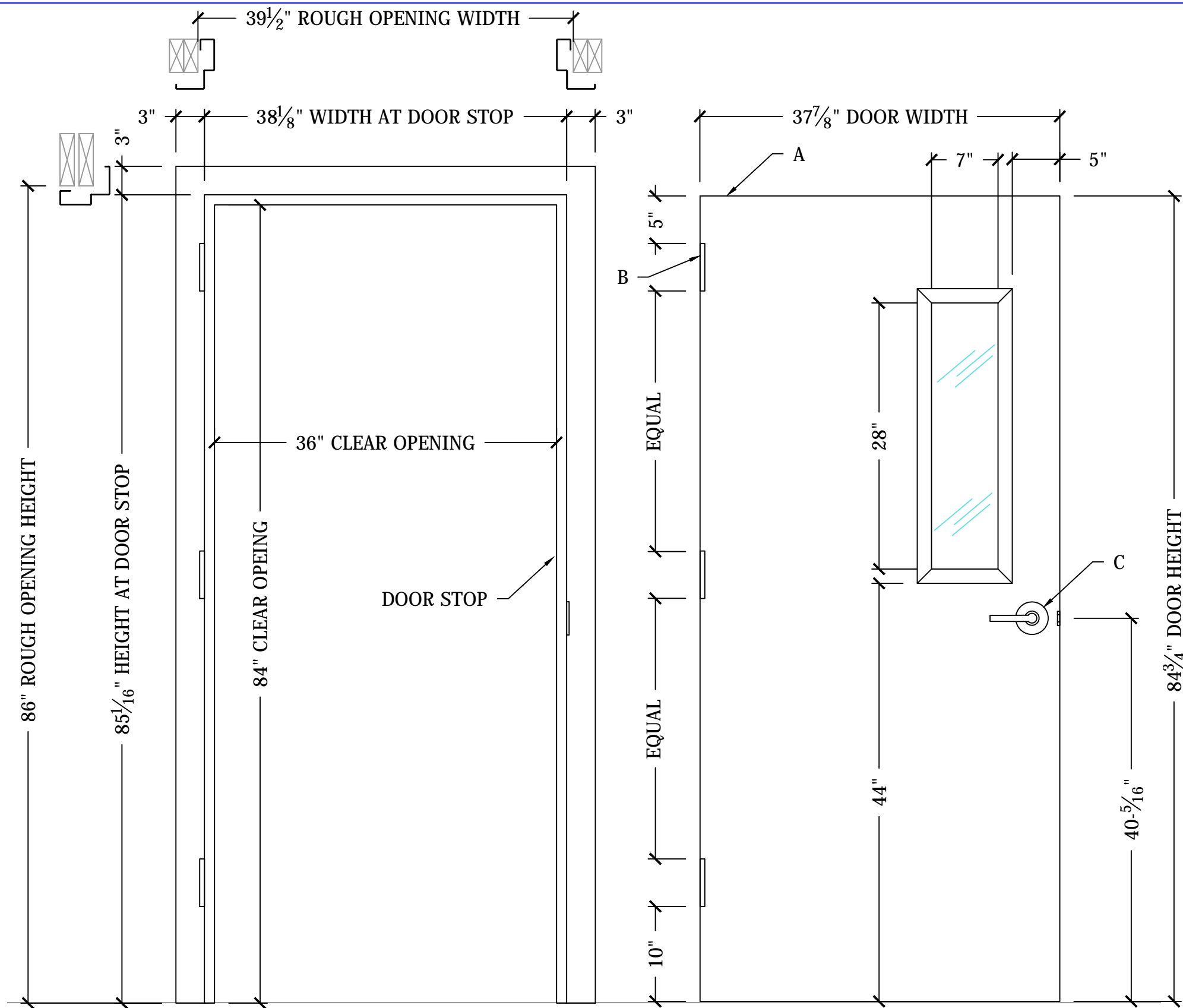

NOTES:

ELEVATION
SCALE: N.T.S.

SOUNDPROOF STEEL DOORS ARE CUSTOM MADE WITH EASY TO INSTALL SLIP-IN FRAMES.

LEGEND:

- A. 1.75" THICK SOUNDPROOF STEEL DOOR..
- B. 3 CAM LIFT 900# CAPACITY HINGES - STANDARD.
- C. MANUFACTURED TO RECEIVE STANDARD LOCKSETS OR LOCKSET OF YOUR CHOICE.

A NARROW LITE STEEL DOOR
SCALE: N.T.S.



**SOUNDPROOF
WINDOWS, INC.**

soundproofwindows.com
1.877.438.7843
1.877.226.4063 fax

STEEL DOOR MODEL 175C1 - 03

NOTES:

SOUNDPROOF STEEL DOORS ARE CUSTOM MADE WITH EASY TO INSTALL SLIP-IN FRAMES.

LEGEND:

- A. 1.75" THICK SOUNDPROOF STEEL DOOR..
- B. 3 CAM LIFT 900# CAPACITY HINGES - STANDARD.
- C. MANUFACTURED TO RECEIVE STANDARD LOCKSETS OR LOCKSET OF YOUR CHOICE.

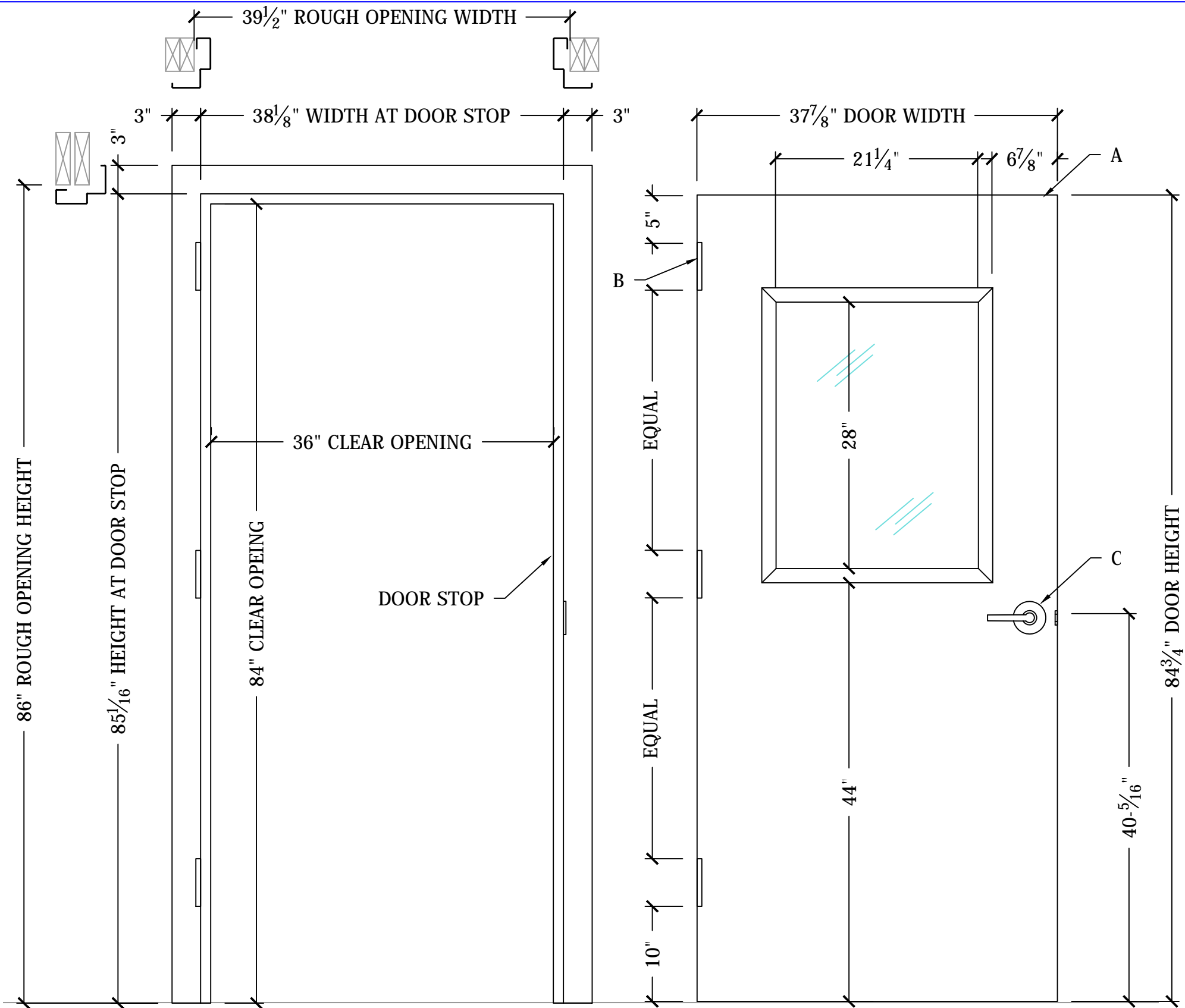

A HALF LITE STEEL DOOR
SCALE: N.T.S.

STEEL DOOR MODEL 175C1 - 04

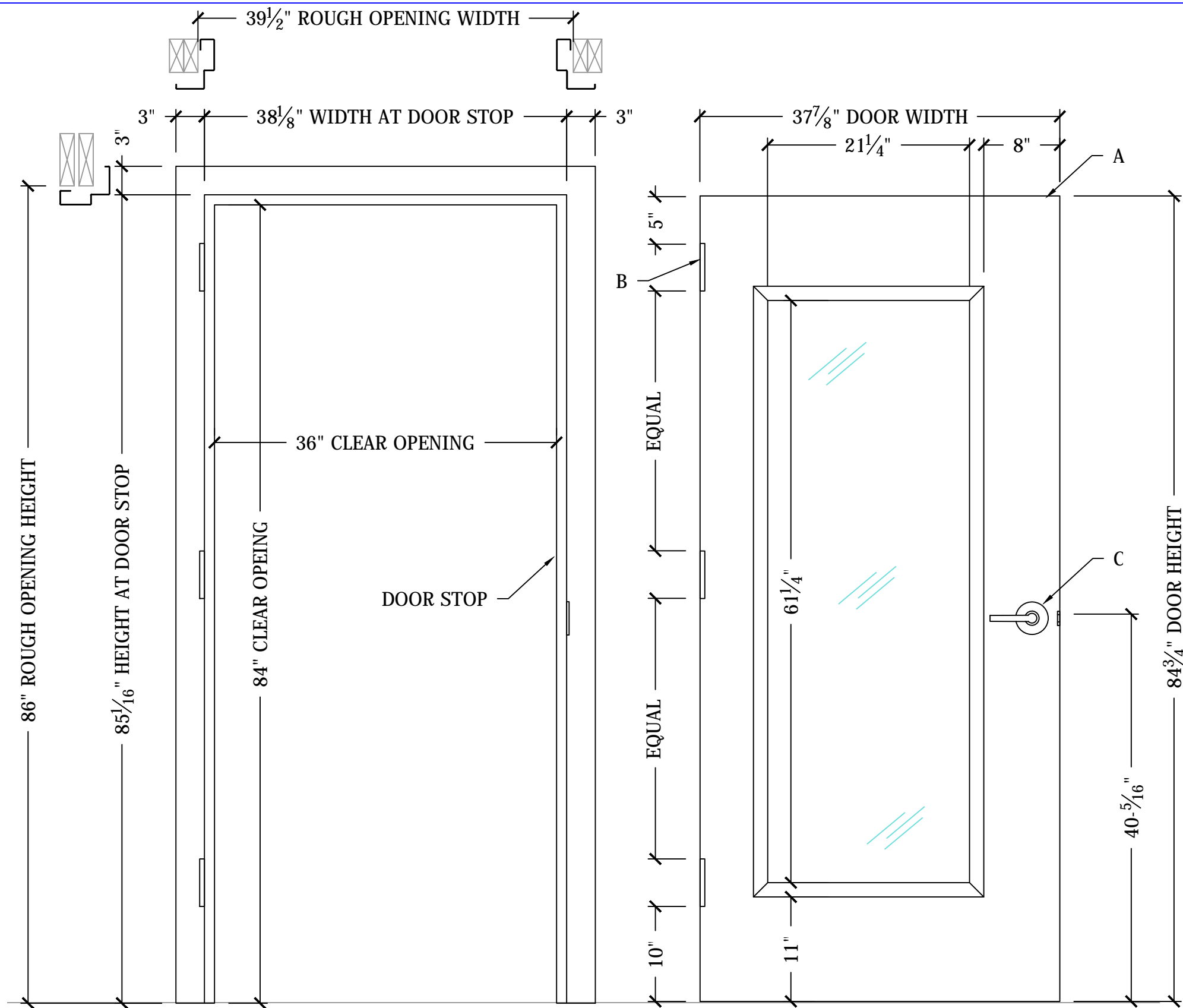

NOTES:

ELEVATION
SCALE: N.T.S.

SOUNDPROOF STEEL DOORS ARE CUSTOM MADE WITH EASY TO INSTALL SLIP-IN FRAMES.

LEGEND:

- A. 1.75" THICK SOUNDPROOF STEEL DOOR..
- B. 3 CAM LIFT 900# CAPACITY HINGES - STANDARD.
- C. MANUFACTURED TO RECEIVE STANDARD LOCKSETS OR LOCKSET OF YOUR CHOICE.

A FULL LITE STEEL DOOR
SCALE: N.T.S.

 **SOUNDPROOF[®]
WINDOWS, INC.**
soundproofwindows.com
1.877.438.7843
1.877.226.4063 fax

STEEL DOOR MODEL 175C1 - 05

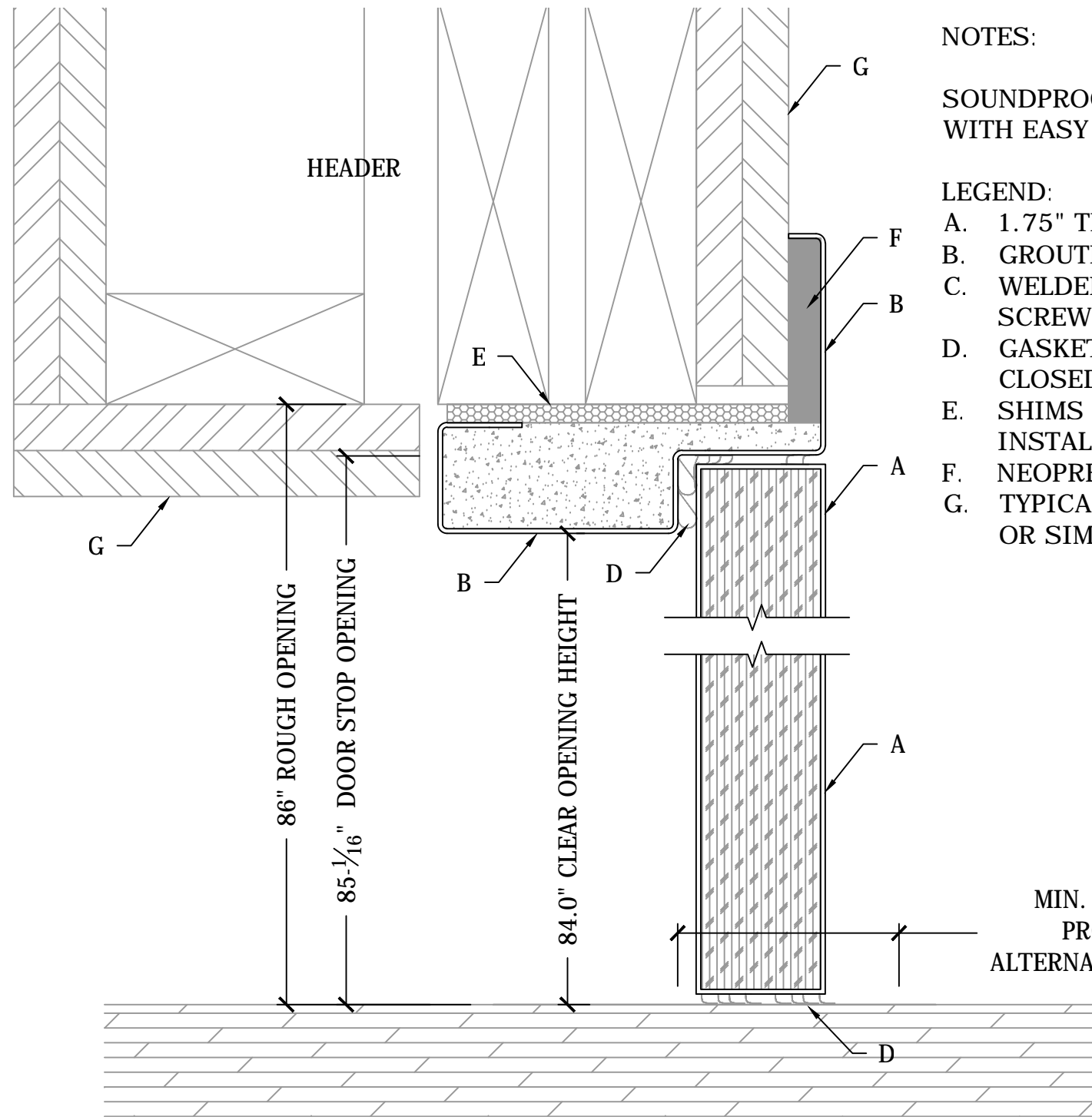

NOTES:

HORIZONTAL SECTION
SCALE: 1:2

SOUNDPROOF STEEL DOORS ARE CUSTOM MADE WITH EASY TO INSTALL SLIP-IN FRAMES.

LEGEND:

- A. 1.75" THICK SOUNDPROOF STEEL DOOR.
- B. GROUTED DOOR FRAME (FURNISHED).
- C. WELDED MOUNTING BRACKET W/ MOUNTING SCREWS AT JAMB SIDES ONLY.
- D. GASKETS & SEALS UNSEEN WHEN DOOR IS CLOSED.
- E. SHIMS AND ACOUSTIC CAULK FILL BY INSTALLER.
- F. NEOPRENE ACOUSTIC FOAM (FURNISHED).
- G. TYPICAL TWO LAYER DRY WALL CONSTRUCTION OR SIMILAR WALL FINISH BY OTHERS.

MIN. 3" FLAT AND SMOOTH SILL AREA
PROVIDE 1/8" CLEARANCE ABOVE
ALTERNATIVE FLOOR FINISHES (I.E.. CARPET)

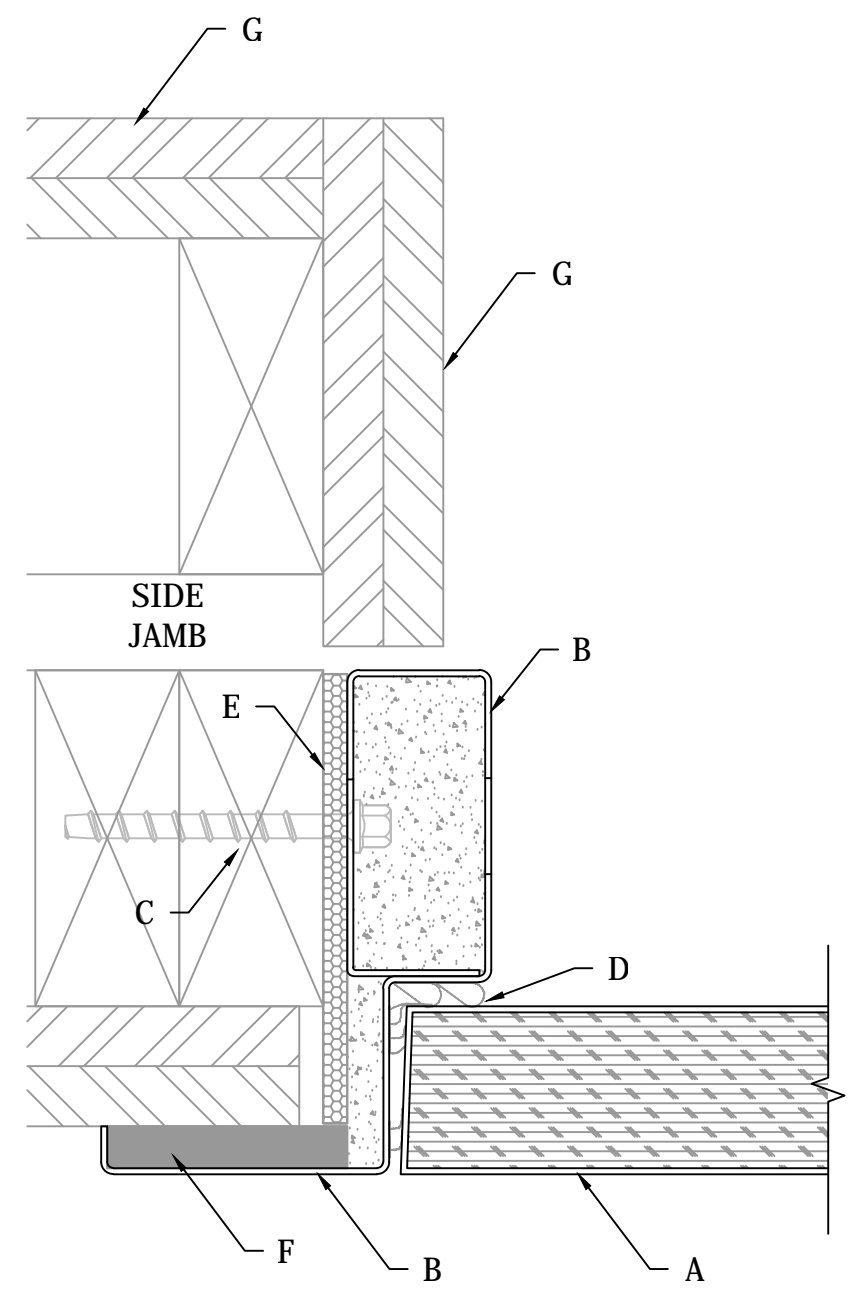

86" ROUGH OPENING
85-1/16" DOOR STOP OPENING
84.0" CLEAR OPENING HEIGHT

A SIDE JAMB SECTION DETAIL
SCALE: 1:2

B HEADER & SILL SECTION DETAIL
SCALE: 1:2



**SOUNDPROOF[®]
WINDOWS, INC.**
soundproofwindows.com
1.877.438.7843
1.877.226.4063 fax

STEEL DOOR MODEL 175C1 - D1

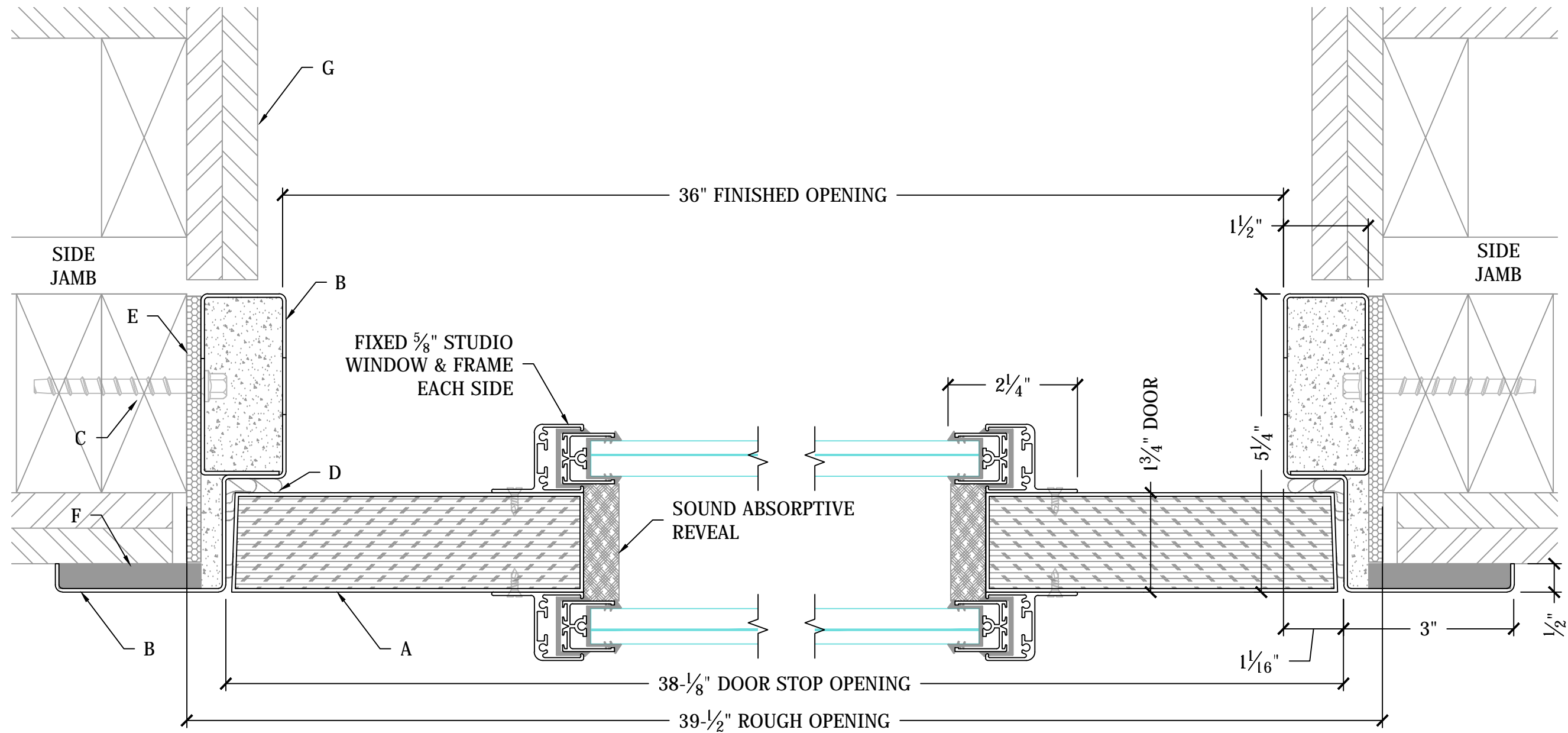

NOTES:

DIMENSIONS SHOWN FOR A 36" WIDE DOOR WITH TYPICAL DOUBLE STUD WALL CONSTRUCTION.

LEGEND:

- A. 1.75" THICK SOUNDPROOF STEEL DOOR.
- B. GROUTED DOOR FRAME (FURNISHED).
- C. WELDED MOUNTING BRACKET W/ MOUNTING SCREWS AT JAMB SIDES ONLY.
- D. GASKETS & SEALS UNSEEN WHEN DOOR IS CLOSED.
- E. SHIMS AND ACOUSTIC CAULK FILL BY INSTALLER.
- F. NEOPRENE ACOUSTIC FOAM (FURNISHED).
- G. TYPICAL TWO LAYER DRY WALL CONSTRUCTION.

A SIDE JAMB SECTION DETAIL
SCALE: 1:2



**SOUNDPROOF
WINDOWS, INC.**

soundproofwindows.com
1.877.438.7843
1.877.226.4063 fax

STEEL DOOR MODEL 175C1 - D2

LEGEND:

- A. GROUTED DOOR FRAME (FURNISHED).
- B. WELDED MOUNTING BRACKET W/ MOUNTING SCREWS AT JAMB SIDES ONLY.
- C. MOUNTING SCREW ACCESS HOLE.
- D. GASKETS & SEALS UNSEEN WHEN DOOR IS CLOSED.
- E. SHIMS AND ACOUSTIC CAULK FILL BY INSTALLER.
- F. NEOPRENE ACOUSTIC FOAM (FURNISHED).

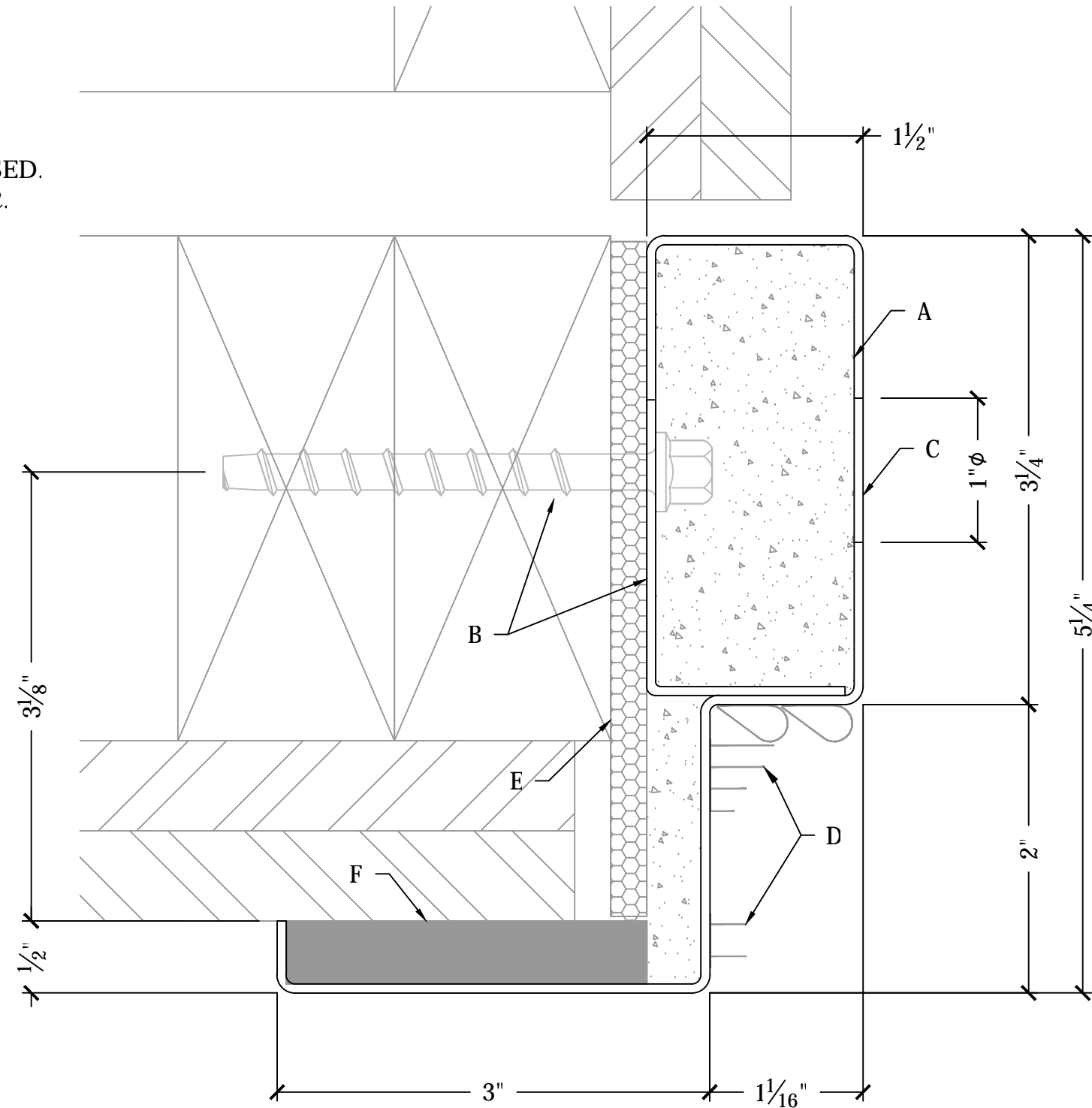

A DOOR FRAME DETAIL

SCALE: 1:1

STEEL DOOR MODEL 175C1 - D3