

STEEL DOORS



56 STC

1.75" Thick

**Cam Lift Hinges
Uses off-the-shelf hardware**



STEEL DOOR Model 175C1



- **Highest STC of Any Acoustical Door**

We offer the highest STC of any 1.75" door offered by any manufacturer in the world. Not just higher but 3+ points higher! Our award winning acoustic design is patent pending.

- **3 Cam Lift Hinges Standard (not just optional)**

Other manufacturers offer two hinges as their standard. Our standard is three heavy weight capacity cam lift hinges (900# capacity). Three hinges should be mandatory for any acoustical door - because of weight, heavy traffic use, and long term maintenance. The cost difference is \$150-200. Look at any building or home - can you find any doors with only two hinges?

- **Uses Off-the-Shelf Locksets and Hardware**

Any standard door hardware can be used on our 1.75" door. No need for \$700 special locksets. No need to use push/pull doors simply to avoid the expensive locksets. Our door is tested using a Home Depot lockset.

- **Wider Doors for Any Given Rough Opening Size**

With a rough opening of 39.5", all other acoustic door manufacturers will give you a clear opening width of 33.5" or less. We will give you a clear opening of 36.0". Our doors are about 3 inches wider than other manufacturers when mounted into the same wall opening.

- **New Door Frame Design**

Our unique slip-in door frame is extraordinarily simple and works best with a double studded wall. Do not short out the isolation between the two walls you spent money and effort building. We attach to one side of your opening - not both. All our door and window designs enhance the double studded walls by NOT connecting across the wall separation.

- **Custom Sizes are Our Standard**

We can make our doors virtually any size.

\$ 4,350.⁰⁰*

- **3070 door with grey primer paint**
- **3 cam lift hinges - 900# capacity**
- **All gasketing and seals**
- **Slip-in door frames**

Full View Glass Option \$ 750.00

Does not include freight, hardware, or installation

* Pricing as of October 2013 - subject to change.



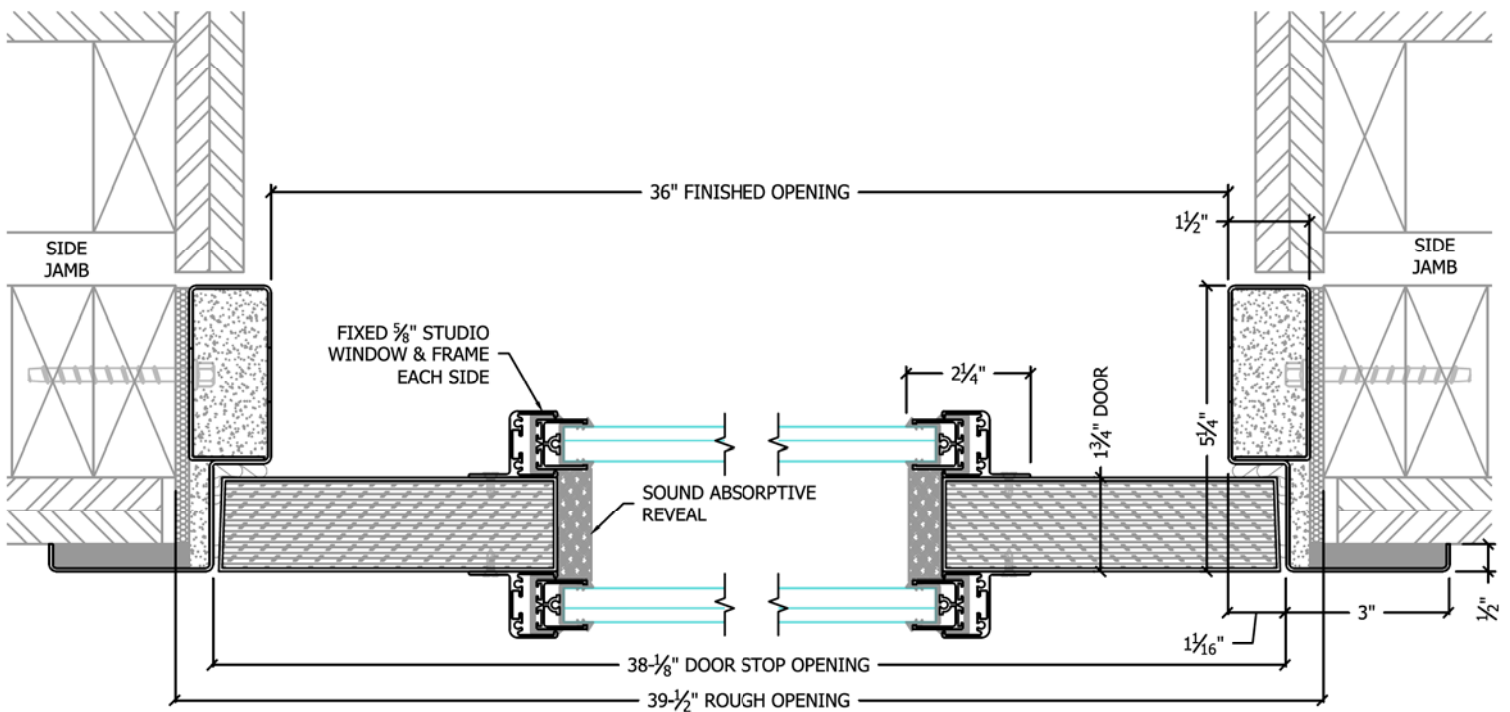
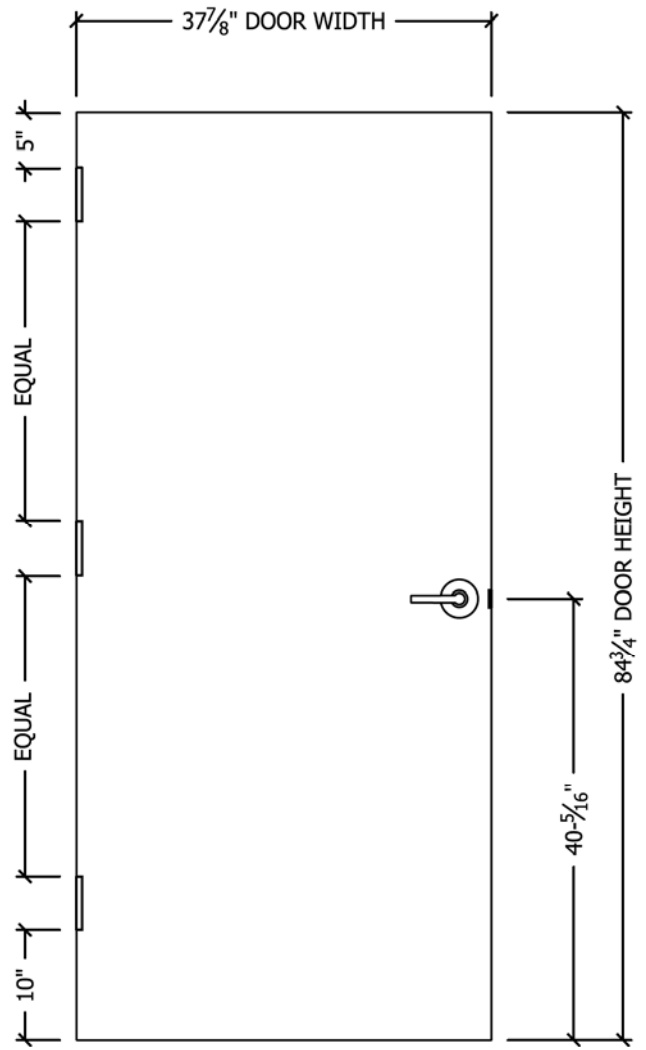
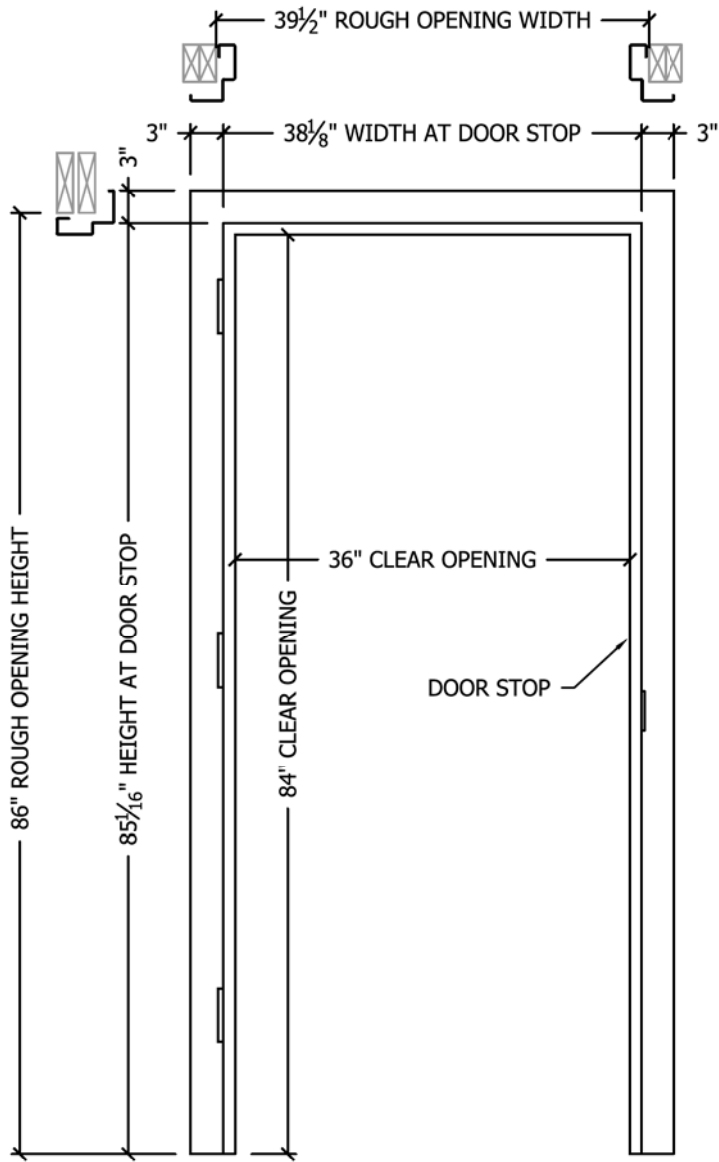

STEEL DOOR

Model 175C

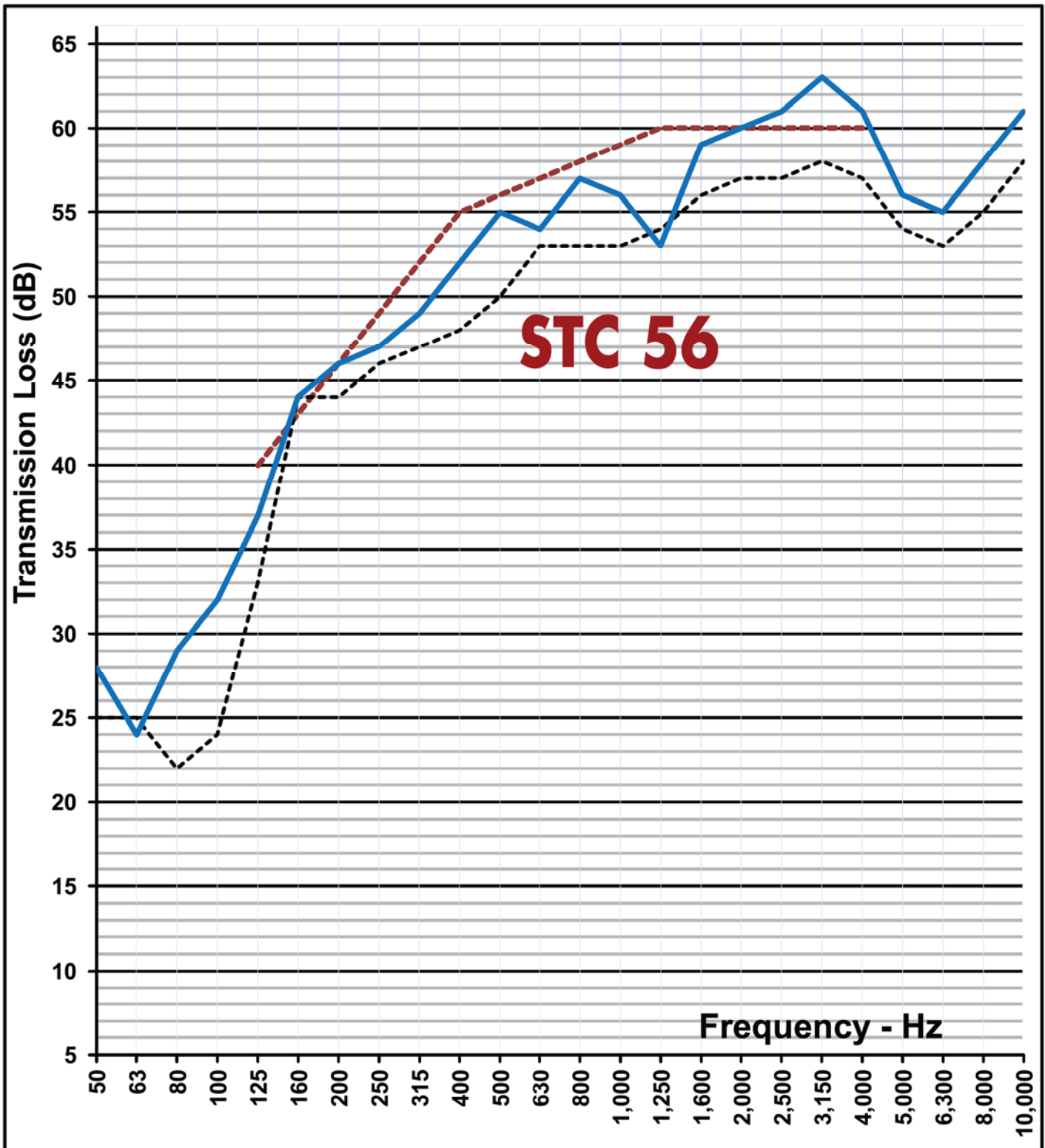

— 175C Steel Door - - - - - 175CG View Lite (5"x29") Steel Door - - - - - 56 STC Curve

by



Our steel doors are fully lab tested in accordance with ASTM E90-09 by NWAALabs. Our 175CG view lite steel door has also been tested by JGL Acoustics. JGL Acoustics used their own equipment and measured the same door installation immediately after the NWAALabs test. Both testing agencies measured the same STC rating with the same TL spectrum within allowable measurement tolerances. Please request our test results package.



4673 Aircenter Circle . Reno, NV 89502 877.438.7843

Who is Soundproof Windows anyway ?

Soundproof Windows, Inc. is the national leader in noise abatement windows. Their soundproofing windows offer STC values from 48 to 57 and work as a second window behind any existing residential or commercial window. Since 1998 they have been developing and perfecting high quality acoustic windows and doors. Now their technology, experience, and expertise is being used to develop products for the recording studio industry. The Soundproof Window studio products are very competitive and they outperform most, if not all, of our competitor's products. Because of the high volume of windows and doors sold by Soundproof Windows in the commercial and residential markets, the recording studio market can now get high quality products at reasonable, volume based prices.

Soundproof Windows has achieved many *FIRSTS* in the Recording Studio Industry:

- **We were the first to offer studio windows with STC values starting in the 60s**
- **We were the first to offer acoustically viable, operable studio windows - also with STCs starting in the 60s**
- **We were the first to offer acoustically viable sliding glass doors - also with STCs starting in the 60s**
- **We are the first to offer standard 1.75" thick doors with STC values above 53**
- **We are the first to offer super clear low-iron glass - standard.**

What's Next ???

- **More high STC products that allow studio designers new and exciting options not previously available**
- **Give us your wish lists! We do listen!**